

# EXTRUDE AND TAP HEIGHT ADJUSTMENT

FOR EXTRUDED  
HOLE SIZE USE  
FLAT MATERIAL  
PREHOLE, IF  
MULTIPLE  
PREHOLE  
DIAMETERS ARE  
LISTED USE 0-.08

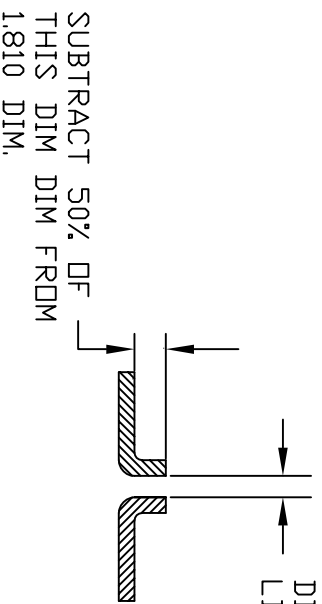

**GOOD**  
GAGE PIN  
GOES THROUGH

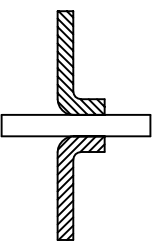

**BAD**  
GAGE PIN  
STOPS

